

SPARE PARTS LIST FOR SHOE REPAIR MACHINE

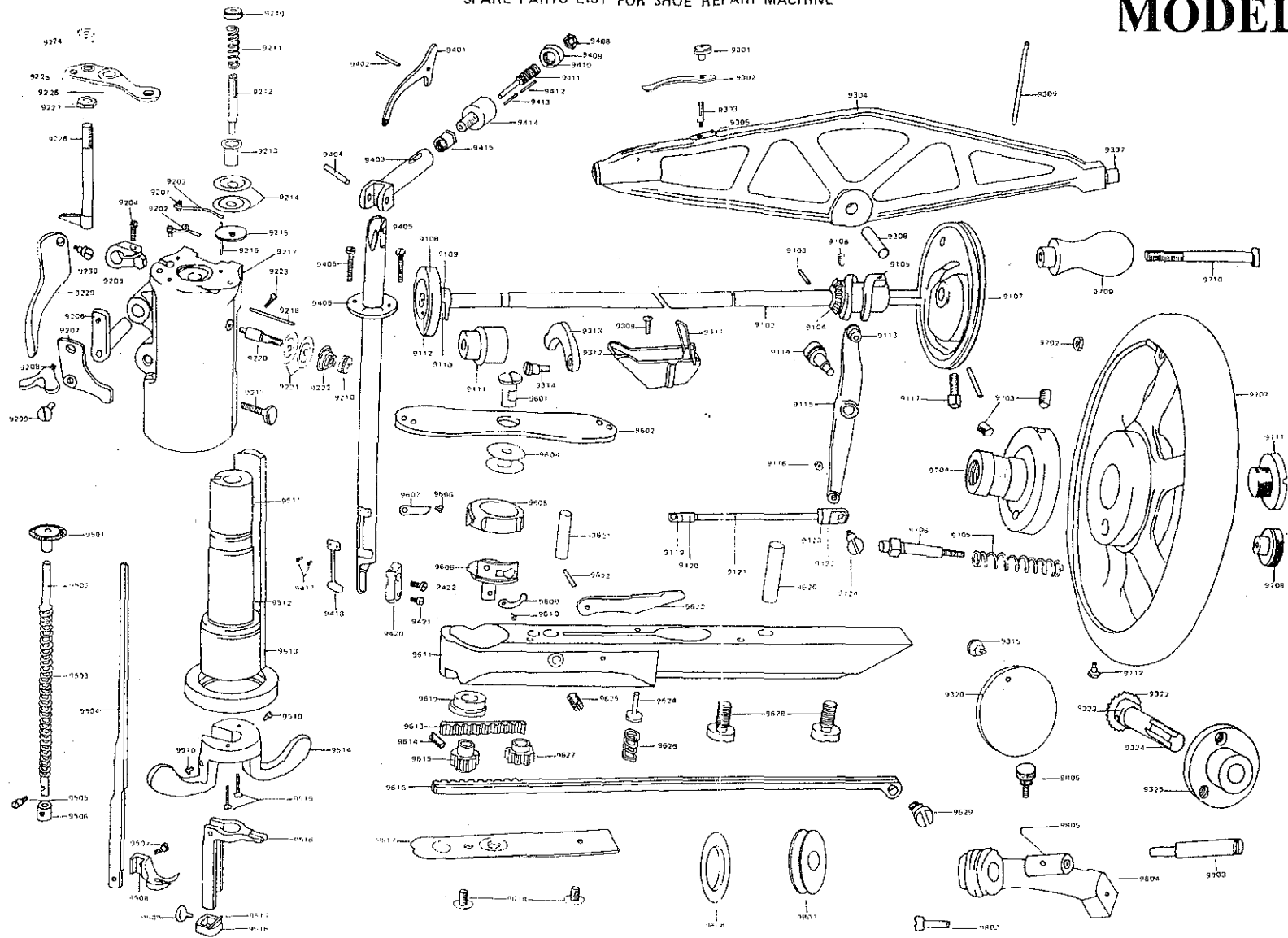

**9101 - 9124**  
**SHAFT, CAM WHEEL, SHUTTLE**  
**DRIVING LEVER, PULLEY**  
**WHEEL AND SHUTTLE DRIVING**  
**LEVER CONNECTING ROD**  
**ASSEMBLY**

- 9101 Shuttle Driving Cam and Gear.
- 9102 Shaft.
- 9103 Pin.
- 9104 Gear.
- 9105 Shuttle Driving Cam.
- 9106 Screw.
- 9107 Needle Bar Cam and Pulley Wheel.
- 9108 Feed Motion Cam Wheel.
- 9109 Cam Wheel Pin.
- 9110 Roller.
- 9111 Shaft Bushing.
- 9112 Roller Pin.
- 9113 Roller and Stud.
- 9114 Bearing Screw.
- 9115 Shuttle Driving Lever.
- 9116 Eccentric Stud Nut.
- 9117 Cam and Pulley Wheel Set Screw.
- 9118 Shuttle Driving Lever Connecting Rod Complete, Nos.
- 9119 Connecting Rod End (front).
- 9120 Pin (front).
- 9121 Connecting Rod.
- 9122 Pin (back).
- 9123 Connecting Rod End (back).
- 9124 Eccentric Stud.

**9201 - 9230**  
**HEAD OF MACHINE AND**  
**TENSIONS COMPLETE**

- 9201 Screw.
- 9202 Thread Eyelet (head of arm).
- 9203 Friction Spring.
- 9204 Clamping Screw.
- 9205 Lifting Lever Shaft Lever.
- 9206 Lifting Lever Shaft.
- 9207 Lifting Lever Shaft Adjusting Lever.
- 9208 Clamping Screw.
- 9209 Hinge Screw.
- 9210 Tension Thumb Nut (2).
- 9211 Tension Spring.
- 9212 Adjusting Stud (top).

- 9213 Cup (release).
- 9214 Disc (2).
- 9215 Washer (leather).
- 9216 Friction Spring Pin.
- 9217 Head of Machine.
- 9218 Thread Guide Pin (side).
- 9219 Head Revolving Bush Stop Thumb Screw.
- 9220 Adjusting Stud (side).
- 9221 Disc (2).
- 9222 Tension (side) Spring.
- 9223 Head Binding Screw (4).
- 9224 Slide Rod Lock Nut (upper).
- 9225 Foot Bar Revolving Joint Bearing.
- 9226 Hinge Pin.
- 9227 Lock Nut (lower).
- 9228 Slide Rod.
- 9229 Lifter.
- 9230 Hinge Screw.

**9301 - 9325**  
**ARM SIDE COVERS, SHUTTLE**  
**DRIVING AND LIFTING LEVERS**

- 9301 Stud Nut.
- 9302 Spring.
- 9303 Spring Stud.
- 9304 Needle Bar Driving Lever.
- 9305 Spring Stead Pin.
- 9306 Spool Pin.
- 9307 Cam Roller and Stud.
- 9308 Joint Pin.
- 9309 Oil Cup Screw.
- 9310 Oil Cup with 8597 and 8695
- 9311 Spring.
- 9312 Oil Pad (cloth).
- 9313 Vibrating Presser Lifting Lever (for medium work).
- 9314 Lifting Lever Screw.
- 9315 Thumb Screw.
- 9320 Arm Side Cover (back).
- 9321 Hand Wheel Hub Complete, Nos. 11663, 81869, 82008 and 82052 for use when Hand Wheel is fitted on front of Machine.
- 9322 Hand Wheel Shaft Gear.
- 9323 Gear Pin
- 9324 Shaft.
- 9325 Hub.

**9401 - 9422**  
**CHECK LEVER AND NEEDLE**  
**BAR COMPLETE**

- 9401 Check Lever
- 9402 Joint Pin.
- 9403 Piston Joint.
- 9404 Joint Pin.
- 9405 Washer Screw (2).
- 9406 Head Revolving Bush Supporting Washer.
- 9407 Check Lever Thread Take-up Adjusting Screw with Indicator complete.
- 9408 Lock Nut
- 9409 Index Head.
- 9410 Index Head Stop Pin.
- 9411 Adjusting Screw.
- 9412 Locating Plunger.
- 9413 Spring.
- 9414 Indicator Body.
- 9415 Indicator Body Lock Nut. Needle Bar complete.
- 9416 Needle Bar Complete.
- 9417 Spring Screw (2).
- 9418 Thread Tension Spring.
- 9419 Needle Bar.
- 9420 Needle Bar Clamp
- 9421 Needle Clamping Screw.
- 9422 Clamp Screw.

**9501 - 9518**  
**FOOT BAR AND FOOT BAR**  
**REVOLVING JOINT**

- 9501 Adjusting Nut.
- 9502 Spring Bar.
- 9503 Vibrating Presser Spring.
- 9504 Foot Bar.
- 9505 Collar Screw.
- 9506 Spring Bar Collar.
- 9507 Feeding Foot Screw.
- 9508 Feeding Foot

- 9509 Stitch Regulator Thumb Screw.
- 9510 Joint Screw (2).
- 9511 Roller and Stud.
- 9512 Revolving Bush.
- 9513 Slide Bar.
- 9514 Revolving Bush Handle.
- 9515 Handle Screw (2).
- 9516 Bell Crank Lever.
- 9517 Gib.
- 9518 Stitch Regulator.

**9601 - 1629**  
**NEEDLE PLATES, GEAR BOX**  
**AND SHUTTLE COMPLETE**

- 9601 Needle Plate Hinge Pin.
- 9602 Needle Plate (fine and medium needle holes).
- 9603 Shuttle complete.
- 9604 Bobbin.
- 9605 Shuttle Body.
- 9606 Tension Regulating Screw.
- 9607 Tension Spring.
- 9608 Shuttle.
- 9609 Spring.
- 9610 Spring Screw.
- 9611 Gear Box.
- 9612 Pinion Bushing.
- 9613 Rack (short).
- 9614 Pinion Screw.
- 9615 Driving Pinion.
- 9616 Rack (long).
- 9617 Pinion Cover Plate.
- 9618 Plate Screw (2).
- 9619 Needle Plate (medium and coarse needle holes).
- 9620 Following Pinion Stud.
- 9621 Gear Box Position Pin.
- 9622 Releasing Lever Hinge Pin.
- 9623 Releasing Lever.
- 9624 Locating Plunger.
- 9625 Needle Plate Hinge Pin Binding Screw.
- 9626 Plunger Spring.
- 9627 Following Pinion.
- 9628 Gear Box Screw (2).
- 9629 Connecting Rod Hinge Screw.

**9701 - 9712**  
**HAND WHEEL AND STOP**  
**MOTION COMPLETE**

- 9701 Hand Wheel and Stop Motion complete.
- 9702 Nut.
- 9703 Binding Screw (2).
- 9704 Hand Wheel Stop Motion Flanged Bushing.
- 9705 Spring.
- 9706 Stop Motion Plunger.
- 9707 Hand Wheel.
- 9708 Plunger Thumb Nut.
- 9709 Handle (wood).
- 9710 Spindle.
- 9711 Retaining Screw.
- 9712 Plunger Stop Screw.

**9801 - 9808**  
**BOBBIN WINDER COMPLETE**

- 9801 Bobbin Winder complete.
- 9802 Frame Screw.
- 9803 Spindle.
- 9804 Frame.
- 9805 Eccentric.
- 9806 Eccentric Thumb Screw.
- 9807 Pulley.
- 9808 Rubber Ring.
- Spindle.

**9851 - 9863**  
**ACCESSORIES**

- 9851 Oiler.
- 9855 Screw Driver (machine).
- 9856 Screw Driver (shuttle tension).
- 9857 Machine Screw (for fastening Machine to Power Table) (4).
- 9859 Machine Screw (for fastening Machine to Stand) (4).
- 9863 Threading Wire.