

# MAIMIN MINI-SHERE INSTRUCTIONS & PARTS LIST

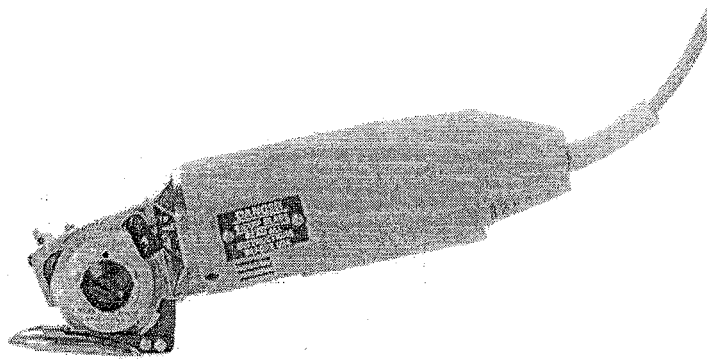

## I. DESCRIPTION

### 1-1 GENERAL

The Maimin Mini-Shere electric shears is a compact, efficient tool for easily cutting various materials. The Mini-Shere uses a hexagonal knife with either a baseplate or a cutting guide for different cutting purposes as listed below. Lubrication by the rear felt (10390) behind the knife greatly increases life of the gear retainer (10313) and improves the cutting action.

### 1-2 KNIFE

The hexagonal knife (30312) is excellent for cutting all materials such as cloth, synthetics, leather, and plastics.

### 1-3 BASEPLATE/CUTTING GUIDE

- a) The baseplate (10345) is used for general cutting.
- b) The cutting guide (10340) is used for trimming, angle cutting, and slitting or cutting knitwear.

## II. OPERATION

### 2-1 TO START

Connect male plug at end of power supply cable to electrical outlet of same voltage as stamped on nameplate. To operate machine, press switch lever (10411). Release lever to stop machine.

The Mini-Shere is double-insulated and requires no grounding. Therefore, it comes equipped with only a two wire electrical cord. The Standard Mini-Shere

## III. CARE & MAINTNANCE

### 3-1 MAINTENANCE SCHEDULE

- a) Daily: Use Mini-Shere oil (10442) to saturate rear felt (10390) whose oil hole is marked in back of gear case (10306).
- b) Weekly: Grease gears with Mini-Shere grease. Grease hole is in back of gear case (10306).
- c) Monthly: Blow out air inlets and outlets of motor. Always keep Mini-Shere free of dirt and grease.

### 3-2 TO CHANGE KNIFE

Turn knife until its hole is opposite recess for sharpener, and insert a hex key into hole. Unscrew knife lock screw (10433) with screw driver. Lift knife out. Slip new knife between counter-cutting blade (10341) and cutting guide (10340), and seat it firmly on shoulder of gear (10310). Lock knife with knife lock screw. Clean cutting requires counter-cutting blade brush only edge of knife.

### 3-3 TO CONVERT BASEPLATE TO CUTTING GUIDE

To expose the cutting guide (10340), remove the baseplate (10345) by unscrewing the two screws (10347) holding the baseplate to the cutting guide. Be careful to keep the two screws with the baseplate for reassembly later if desired.

### 3-4 TO CHANGE SHARPENING STONE

Remove knife then sharpening stone (10378) from

# MINI-SHERE PARTS LIST

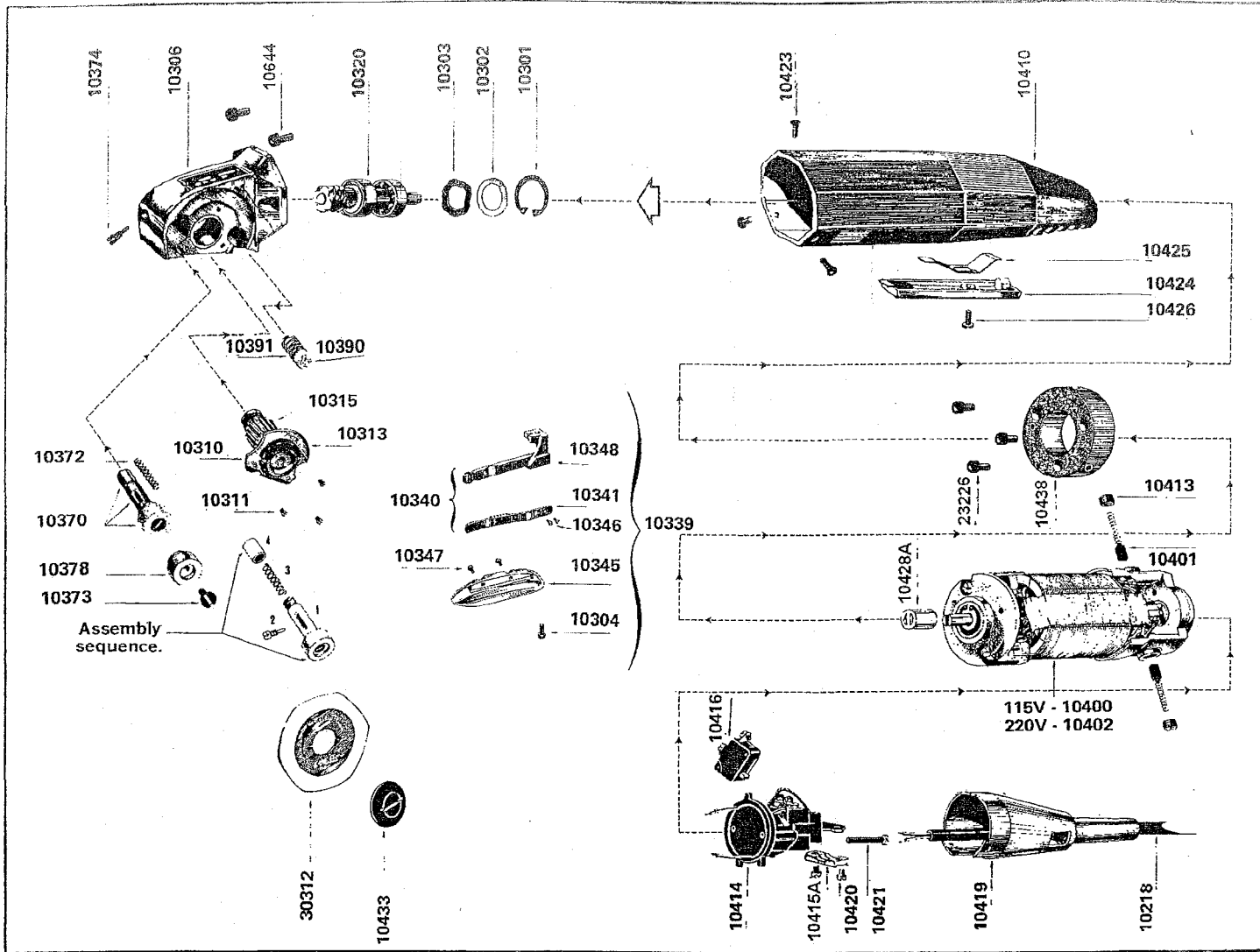

Part No.	Description	Part No.	Description	Part No.	Description
10218	Power Supply Cable	10372	Spring	10442	Oil
10250	Motor Bearing Front	10373	Stone Screw	10443	Grease
10251	Motor Bearing Back	10374	Shaft Screw	10644	Screw M4 X 10 Cap
10301	Retaining ring	10375	Cap	30312	Hexagonal Blade
10302	Washer	10378	Sharpening Stone		
10303	Undulated Washer	10390	Rear felt	<b>Stretch Minishere</b>	
10304	Screw, M4 X 8 Cap	10391	Spring	10328	Motor Adapter Flange
10306	Gear Case	10400	Motor Assembly 110V	10329	Gear Case Adaptor Flange
10310	Gear Assembly	10401	Carbon Brush, Each	10331	Motor Shaft
10311	Screw, M2.6 X 3	10402	Motor Assembly 220V	10333	Screw (Switch Box)
10313	Gear Retainer	10410	Motor Case	10334	Grip
10315	Gear Only	10411	Switch Lever	10336D	Motor Shaft Housing Assembly
10320	Worm Assembly	10413	Brush Cap	10352	Screw, Socket, Cone Pt.
10324	Rollpin 2 X 10	10414	Holder Only	10361	Switch Box
10325	Retaining Ring	10415A	Clip	10362	Switch Box Bracket
10339	Cutting Guide Assembly	10416	Switch	10407B	Motor Assembly 110V
10340	Cutting Guide w/Blade	10419	Sheath	10409B	Motor Assembly 220V
10341	Counter Cutting Blade	10420	Screw 4 X 5/16	10428A	Coupling
10345	Baseplate	10421	Screw 3 X 1-1/16	10717A	Switch
10346	Screw, M2.6 X 3	10423	Screw M3 X 8	824T	Screw (Switch Box Bracket)
10347	Screw, M3 x 6	10425	Spring		
10348	Cutting Guide Only	10426	Screw M3 X 4		
10349	Clamp (Not Shown)	10428A	Shaft Coupling		
10370	Sharpener Assembly	10433	Knife Lock Screw		
		10438	Disc		
		10441	Hex Key M3		